

Catalog Number:	Project Name:	Note:	Date:	Type:
-----------------	---------------	-------	-------	-------

DESCRIPTION

Portor's AL1 Area Light Series features energy efficient and provide advanced optical control. The ultra slim profile deliver enhanced performance for general area lighting applications. The robust die-cast housing provides excellent thermal management for longer life and can withstand everyday harsh outdoor environments. The tool-less access to driver makes it easy for maintenance and value add accessories.

Ideal use for parking lots, car dealerships, walkways, school campuses, shopping centers and industrial areas



CONSTRUCTION

Die-Cast aluminum body combine with state of the art heat dissipation and tool-less access to driver housing makes the AL1 a one of a kind area light. Waterproof, built rugged for outdoor harsh condition.

ELECTRICAL

Luminaire is built with the highest quality driver that is Universal Voltage (100V-27V), uses long lasting, high-efficient LED packages. Water resistant LED chips (custom order available for 347V-480VAC driver).

OPTICAL SYSTEM

Comes standard with Type III optics designed to reduce glare and improve light distribution through precision formed lens optics. Type V is optional.

MOUNTING

Multiple mounting options available: Slipfitter, square-pole mount, round-pole mount, wall mount and trunnion mount. Pole options also available.

SENSOR READY

Motion sensor and Photocell sensor available, can do in-house installation.

DIMMING

0-10V dimmable (1-10V dimming on AL1-300W model)

ENERGY SAVINGS

Over 70% energy savings than traditionally fluorescent fixtures, low heat productions requires less maintenance and operation cost.

LISTING

ETL Listed, FCC, RoHS, CE, DLC Premium Listed, IP65 rated with LM79 and LM80 report

WARRANTY

5 year Limited Warranty, Rated for 50,000 hours. See Warranty documentation for details.

WATTAGE	DELIVERED LUMENS	EFFICACY
100W	15,526	155 lm/W
150W	24,515	156 lm/W
200W	31,218	160 lm/W
240W	35,569	148 lm/W
300W	45,313	154 lm/W

TECHNICAL SPECIFICATION

CCT	3000K*, 4000K*, 5000K
CRI	80+
DIMMABLE	0-10V dimming
SENSOR	Photocell/Motion Sensor ready
VOLTAGE	100V-277V
POWER FREQUENCY	50/60 Hz
POWER FACTOR	>0.93
THD	≤10%
WORKING TEMPERATURE	-40°F ~ 122°F
IP RATING	IP65 Wet Location
LIFE SPAN	50,000 hrs
WARRANTY	5 year limited



ORDERING SAMPLE: - - - - - - - -

Series	Wattage	CCT	Voltage	Finish	Distribution	Accessories/Options		
PT-AL1 LED Area Light Series	100W	30K (3000K)*	LVSG (100V/277V)	Blank (Standard Bronze) W (White)	T3 (Type III) T5 (Type V)	*Mounting (select one)	Sensor/Photocell	Other
	150W	40K (4000K)*				SF-(W)-AL1	MSA-D	SP
	200W	50F (5000K)				SPM-(W)-AL1	PC	
	240W					SAM-(W)-AL1	PC-HV	
	300W**					TM-(W)-AL1		
		* special order required				RPMA-(W)-AL1		

** (1-10V dimming)

* for white finish, add "W" on the mounting option

Catalog Number:	Project Name:	Note:	Date:	Type:
-----------------	---------------	-------	-------	-------

DIMENSION

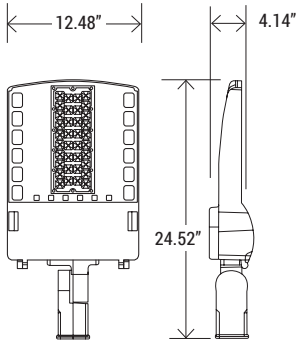

PT-AL1-100W-5K

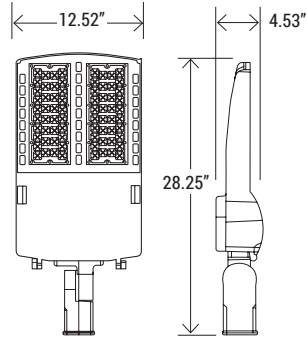

PT-AL1-150W-5K / PT-AL1-200W-5K

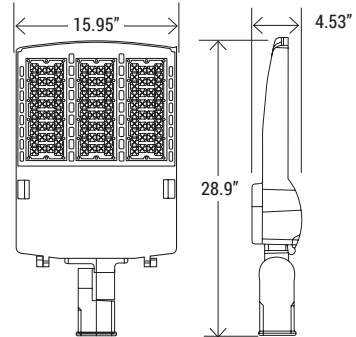

PT-AL1-240W-5K / PT-AL1-300W-5K

MOUNTING OPTION



SF-AL1 / SF-W-AL1
Slipfitter



SPM-AL1 / SPM-W-AL1
Adjustable Mount For
Square Pole



SAM-AL1 / SAM-W-AL1
Straight Arm Mount for
Square Pole



TM-AL1 / TM-W-AL1
Trunnion Mount



RPMA-AL1 / RPMA-W-AL1
Round Pole Mount Adapter

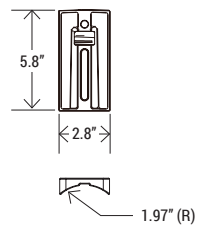
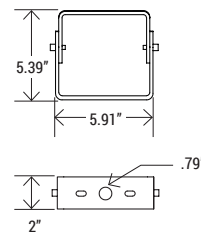
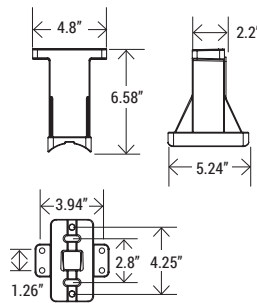
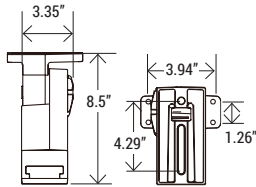
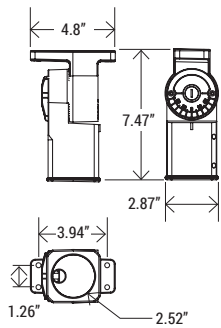

SENSOR OPTION



MSA-D
Microwave motion sensor



PC
Photocell (120V-277V)



PC-HV
Photocell (480V)



SP
Surge Protector

Catalog Number:	Project Name:	Note:	Date:	Type:
-----------------	---------------	-------	-------	-------

PT-AL1-100W-5K

EPA	0.7 ft²
Net Weight	11.79 lbs
Gross Weight	13.34 lbs
Dimension	24.52" x 12.48" x 4.14"

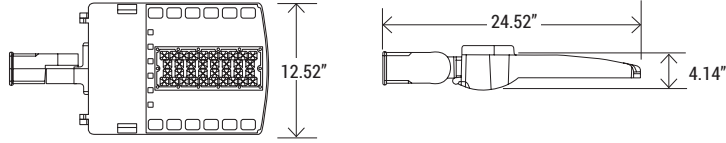

CONFIGURATION						
EPA	0.7 ft²	1.4 ft²	1.1 ft²	1.8 ft²	1.65 ft²	2.2 ft²
Net Weight	11.79 lbs	23.58 lbs	23.58 lbs	35.37 lbs	35.37 lbs	47.16 lbs

PT-AL1-150W-5K / PT-AL1-200W-5K

EPA	0.9 ft²
Net Weight	12.86 lbs / 17.97 lbs
Gross Weight	19.40 lbs / 19.73 lbs
Dimension	28.25" x 12.52" x 4.53"

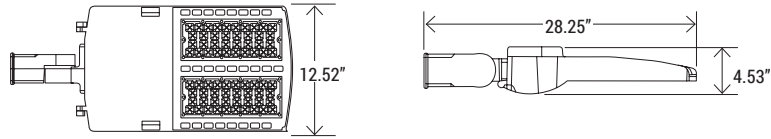

CONFIGURATION						
EPA	0.9 ft²	1.8 ft²	1.3 ft²	2.2 ft²	1.95 ft²	2.6 ft²
Net Weight	12.86 lbs / 17.97 lbs	25.72 lbs / 35.94 lbs	25.72 lbs / 35.94 lbs	38.58 lbs / 53.91 lbs	38.58 lbs / 53.91 lbs	51.44 lbs / 71.88 lbs

PT-AL1-240W-5K / PT-AL1-300W-5K

EPA	0.91 ft²
Net Weight	22.71 lbs / 25.13 lbs
Gross Weight	24.91 lbs / 27.34 lbs
Dimension	28.9" x 15.95" x 4.53"

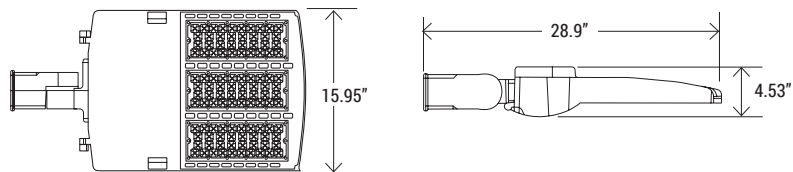

CONFIGURATION						
EPA	0.91 ft²	1.82 ft²	1.41 ft²	2.32 ft²	2.73 ft²	2.82 ft²
Net Weight	22.71 lbs / 25.13 lbs	45.42 lbs / 50.26 lbs	45.42 lbs / 50.26 lbs	68.13 lbs / 75.39 lbs	68.13 lbs / 75.39 lbs	90.84 lbs / 100.52 lbs

Catalog Number:	Project Name:	Note:	Date:	Type:
-----------------	---------------	-------	-------	-------

PHOTOMETRY

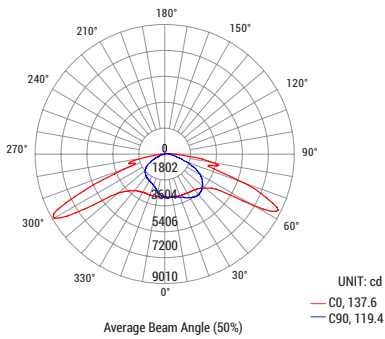

PT-AL1-100W

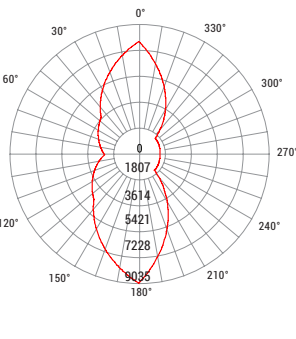

PT-AL1-150W

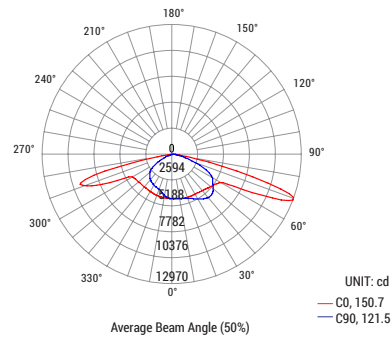

PT-AL1-200W

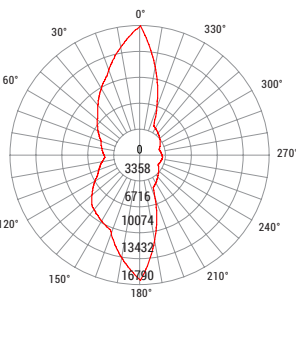

PT-AL1-240W

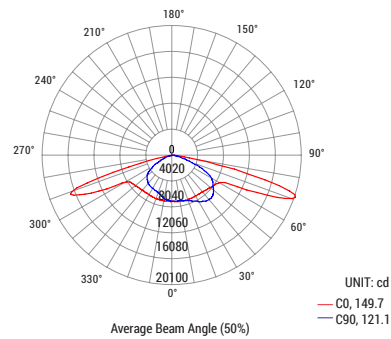

PT-AL1-300W



DLC LISTING

CATALOG NUMBER	WATTAGE	DELIVERED LUMENS	EFFICACY	DLC PRODUCT ID	CLASSIFICATION
PT-AL1-100W-50F-LVSG	100W	15,526	155 lm/W	PHTYEZUY	PREMIUM
PT-AL1-150W-50F-LVSG	150W	24,515	156 lm/W	PE58Q9EH	PREMIUM
PT-AL1-200W-50F-LVSG	200W	31,218	160 lm/W	PJPQ525W	PREMIUM
PT-AL1-240W-50F-LVSG	240W	35,569	148 lm/W	P7RH8NAF	PREMIUM
PT-AL1-300W-50F-LVSG	300W	45,313	154 lm/W	P5FZ3B32	PREMIUM